

ICBIC-30RID



## FEATURES

All-refrigerator storage solves capacity problems

Ready to be fitted with custom panels and handles to blend with cabinetry

Air purification system fights spoilage, odors

Nano-coated spill-proof shelves for easy clean-up

Smart-touch controls for streamlined access to more settings

Internal water dispenser works with seamless design

Water-filtration system for ice reduces contaminants, chlorine taste and odor

Rigorously tested in our U.S. manufacturing facilities to ensure decades of use

Exceptional support from Customer Care team

Soft-close doors and drawers

Soft-on LED lights for varying degrees of brightness

Uniform 2134 mm height

## ACCESSORIES

Stainless Steel Tubular Handles

Stainless Steel Pro Handles

Stainless steel side enclosure

Stainless steel top enclosure

Reduced toe kick divider for toe kicks from 5 cm to 10 cm

Replacement water filter

Accessories are available through an authorized Sub-Zero dealer.  
For local dealer information, visit [www.szwasia.com](http://www.szwasia.com)



## HANDLE ACCESSORIES

PRO



TUBULAR



## PRODUCT DETAILS

### REFRIGERATOR

- Three adjustable glass shelves
- Two crisper drawers with dividers
- Deli drawer with dividers
- Three adjustable door shelves
- Two stationary door shelves
- Adjustable dairy compartment
- Air purification system
- Internal water dispenser
- Water filtration system

## PRODUCT SPECIFICATIONS

|                             |                           |
|-----------------------------|---------------------------|
| Model                       | ICBIC-30RID               |
| Dimensions                  | 762mmW x 2134mmH x 610mmD |
| Door Clearance              | 724mm                     |
| Weight                      | 181 kg                    |
| Refrigerator Gross Capacity | 531 L                     |
| Electrical Supply           | 220-240 VAC; 50/60 Hz     |
| Electrical Service          | ≤ 4 A                     |
| Receptacle                  | 3-prong grounding-type    |

## ELECTRICAL

## PLUMBING

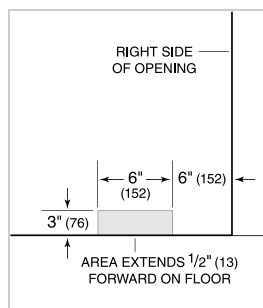
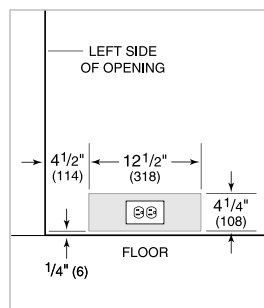

**PANEL SPECIFICATIONS** For complete panel specifications including width/height, weight requirements and thickness requirements visit [subzero-wolf.com/trade-resources/reveal](http://subzero-wolf.com/trade-resources/reveal).

**NOTE:** Dimensions in parenthesis are in millimeters unless otherwise specified

## INTERIOR VIEW

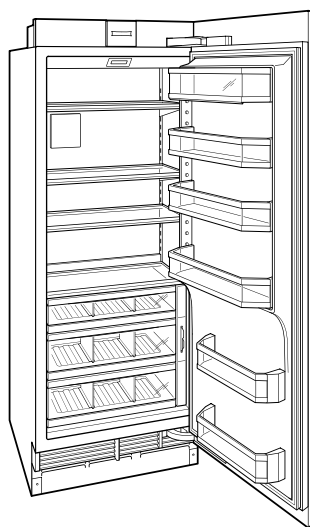

This illustration is intended for interior reference only and may not represent the exterior of the model being specified.

## DIMENSIONS

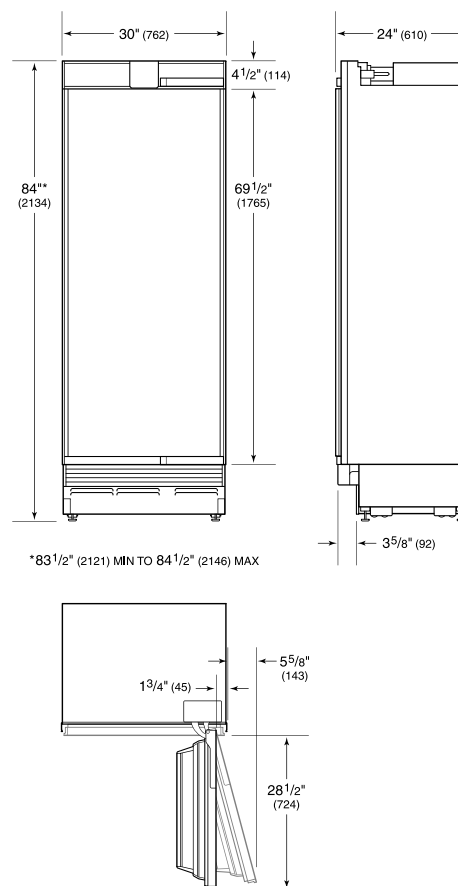

## STANDARD INSTALLATION

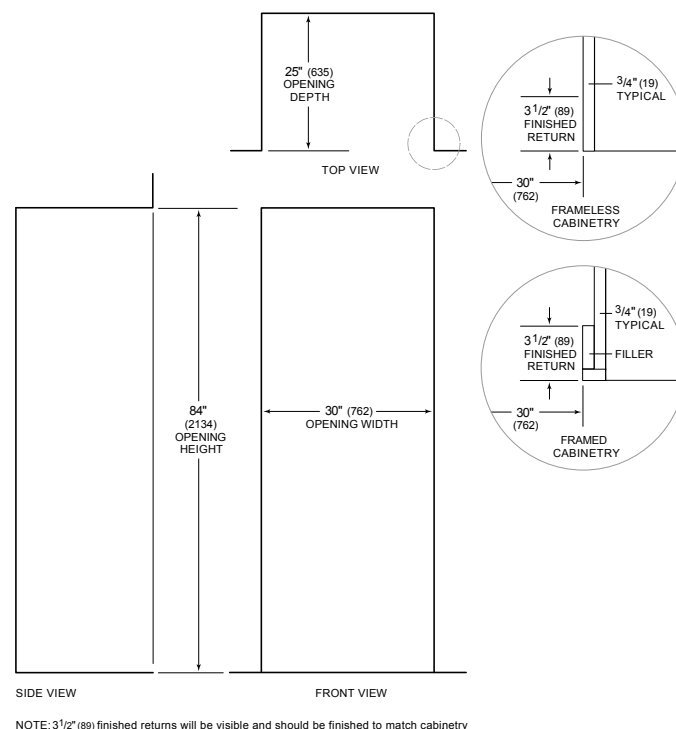

**GUIDE ONLY.**

**THESE SPECIFICATIONS ARE A GUIDE ONLY.** Not suitable for cabinetry, installation or services location.

SUB-ZERO AND WOLF OFFER A CUSTOMISED DESIGN CHECK SERVICE to ensure your new appliances are installed perfectly. Please contact our Customer Care team for further information regarding our Design Check Service, or for detailed product specification and installation advice.

Phone: 03 9600 2218 Email: [customer-care@szw-sea.com](mailto:customer-care@szw-sea.com)

Sub-Zero and Wolf Design Guides are also available via our website: [www.szwasia.com](http://www.szwasia.com)

Specifications are subject to change without notice. This information generated in Apr 2019. Verify specifications prior to finalising your cabinetry and enclosures.